



Beauty. Strength. Durability.



**Digger
Specialties
Inc.**

Transforming the Outdoor Living Experience™



DYNAMIC SOLUTIONS INNOVATION

Since 1984 Digger Specialties, Inc. (DSI) has been manufacturing quality products for the outdoor living industry.

At DSI we are continually working to provide solutions through innovative product development and design to bring the best products to our customers, the marketplace, and the home owner.

PolyRail® Vinyl Fencing offers Privacy, Picket, Ornamental, and Post & Rail styles to complement your outdoor living space.



Digger Specialties, Inc. is proud to offer one of the strongest warranties in the industry. Our Aluminum Lifetime Limited Warranty and our Vinyl Transferrable Lifetime Limited Warranty demonstrates our faith in our product and our commitment to you.

Visit diggerspecialties.com to view and register a DSI warranty.



Digger Specialties, Inc. is proud to be an American company manufacturing quality American made products at our plants in Indiana, North Carolina, Georgia, Pennsylvania, and Missouri.



COMMITTED TO THE ENVIRONMENT AND OUR COMMUNITY

DSI is proud to be an environmentally aware company that continues to update our practices to reduce our carbon foot-print. DSI consistently recycles our cardboard, wood, steel banding, zinc die cast, and heat shrink scrap. DSI also utilizes both aluminum and vinyl extrusions that contain recycled content.

DSI is pleased to support our community by outsourcing a portion of our packaging functions to a local company that provides meaningful employment to individuals with disabilities.



Table of Contents

Features & Benefits	2
Vinyl & Aluminum Colors	3
Privacy Vinyl Fencing	4 - 5
Designer Fencing	6 - 7
Picket Vinyl Fencing	8 - 9
Ornamental Vinyl Fencing	10 - 11
Post & Rail Vinyl Fencing	12 - 13
Standard Gates	14
Aluminum Frame Gates	15
Gate Hardware	16
Accessories	17

FEATURES & BENEFITS

Notched Rails and Snap Buttons

Our Notched Rail and Snap Button systems lock rails into place providing a sturdy and durable rail for your fence.

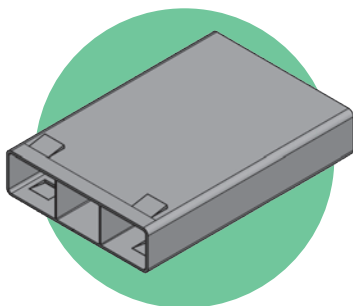

Low Maintenance

PolyRail® Vinyl Fencing offers a low maintenance solution to your outdoor living area. Both our vinyl and aluminum are easy to clean and maintain. For Care and Cleaning Guidelines visit the DSI website.



Matching Walk Gates

All our PolyRail® Vinyl Fencing models have matching aluminum reinforced walk gates to accent your fence. Gates are available in both single and double gate options.

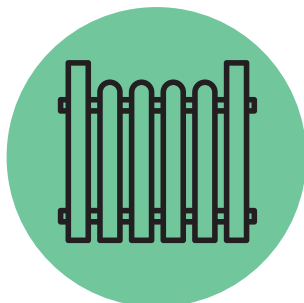

Lifetime Limited Warranty

DSI offers one of the best warranties in the industry. All PolyRail® Vinyl Fencing models are covered by either our Aluminum Lifetime Limited Warranty or our Vinyl Transferrable Lifetime Limited Warranty, offering you peace of mind in your investment.



Pool Code Approved



PolyRail® Vinyl Fencing combines safety with style. Fence models marked with this

symbol comply with ASTM F2409 and 1908 pool codes for height and spacing.

Always check with your local building code authority as local codes may differ.

VINYL & ALUMINUM COLORS

Vinyl Colors

PolyRail® Vinyl Fencing is available in multiple vinyl colors. Some colors are unique to select models. Please see individual style pages for color availability.

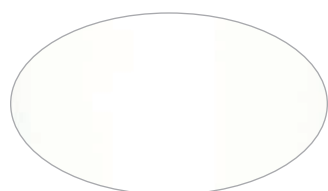

White



Tan



Mocha



Antique Beige



Cottage Grey



Sienna

Colors shown are a close approximation of the true color. Please request actual samples for accurate powder coating colors.

Aluminum Colors

DSI Aluminum Products are available in 12 standard AAMA 2604 colors to compliment your project; from satin color to textured colors. Custom colors and AAMA 2605 colors are available by special order.

Textured Colors



Black Fine Texture



Bronze Fine Texture



Brown Fine Texture



White Fine Texture



Grey Fine Texture

Non Textured Colors



Gloss Beige



Chocolate



Ninety Bronze



Sandy Shore

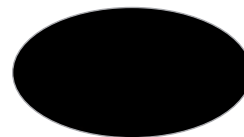

Satin Black



Gloss White



Speckled Walnut



PRIVACY

VINYL FENCING



Privacy Style

PolyRail® Privacy Fencing provides privacy and security for your outdoor living space while offering options and colors to match your style. Whether you are protecting your family and pets or creating a secluded oasis for your pool, our Privacy Fencing will ensure your outdoor living space is safe and beautiful.

Tri-Max II

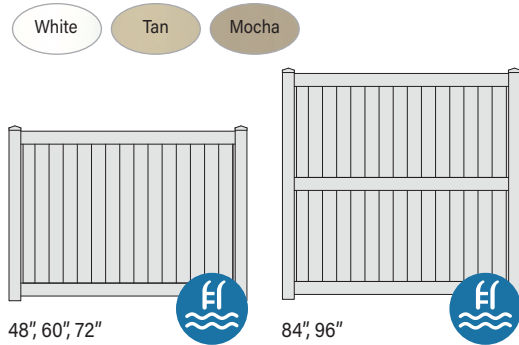

Tri-Max II with Vertical Topper

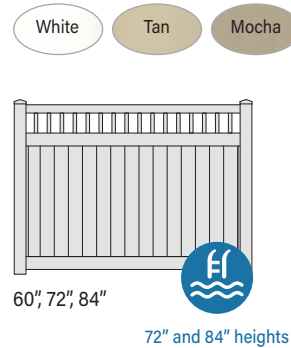

Tri-Max II with Lattice Topper

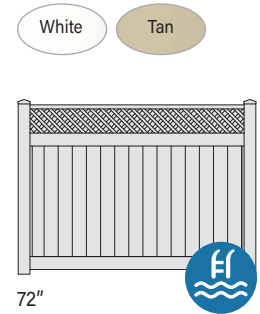

Specifications

Models	Infill Colors	Heights	Racking	Width	Infill Size	Rails	Post Size	Standard Post Cap
Tri-Max II	White Tan Mocha	48", 60", 72"	10" Standard	8'	7/8" x 6" (.045"W) Snap Lock Tongue & Groove	1-1/2" x 5-1/2" (.080"W) Top and Bottom Rail Aluminum Reinforced Bottom Rail	5" x 5" (.135"W Standard and Optional .165"W for 60" and 72" Heights)	Flat Cap
	White Tan Mocha	84", 96"	10" Standard	8'	7/8" x 6" (.045"W) Snap Lock Tongue & Groove	1-1/2" x 5-1/2" (.080"W) Top, Mid, and Bottom Rail Aluminum Reinforced Mid and Bottom Rail	5" x 5" (.165"W)	Flat Cap
Tri-Max II with Vertical Topper	White Tan Mocha	60", 72", 84"	10" Standard	8'	7/8" x 6" (.045"W) Snap Lock Tongue & Groove 7/8" x 1-1/2" (.070"W) Vertical Accent w/ 4-1/8" Spacing	1-3/4" x 3-1/2" (.110"W) Top Rail 1-1/2" x 5-1/2" (.080"W) Mid and Bottom Rail Aluminum Reinforced Bottom Rail 84" Height includes Aluminum Reinforced Mid-Rail	5" x 5" (.135"W Standard and Optional .165"W for 60" and 72" Heights. .165"W Standard for 84" Height)	Flat Cap
Tri-Max II with Lattice Topper	White Tan	72"	10" Standard	8'	7/8" x 6" (.045"W) Snap Lock Tongue & Groove 1-7/8" Diagonal Lattice	1-3/4" x 1-3/4" (.080"W) Top Rail 1-1/2" x 5-1/2" (.080"W) Mid and Bottom Rail Aluminum Reinforced Bottom Rail	5" x 5" (.135"W Standard and Optional .165"W)	Flat Cap

*Aluminum Stiffeners Required in All Line & End Posts for 84" & 96" Heights.

Feature



Reinforced Bottom Rail Prevents Sagging on all Tri-Max II Models



DESIGNER FENCING



Designer Style

Designer Fencing offers the privacy of a vinyl infill with the durability and aesthetics of a powder coated aluminum fence. The aluminum frame and components of Designer Fencing are available in 12 standard AAMA 2604 colors (shown on page 3) and the vinyl infill is available in six colors. Designer Fencing is a perfect way to secure your pool, hot tub, patio, or yard.

Narrow Verticals

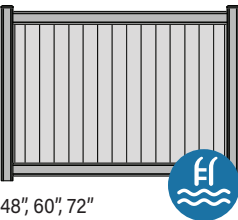

48", 60", 72"
with 6" Verticals

Wide Verticals

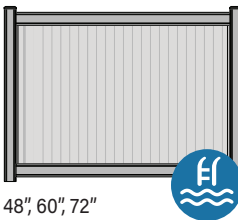

48", 60", 72"
with 11.28" Verticals

Specifications

Models	Frame Colors	Infill Colors	Heights	Racking	Width	Infill Size	Rails	Post Size	Standard Post Cap
Narrow Verticals	Any Standard DSI Aluminum Color (Shown on Page 3)	Antique Beige Cottage Grey Sienna	48", 60", 72"	10" Standard	8' Per Ft. Section Widths Available	7/8" x 6" (.045"W) Snap Lock Tongue & Groove	1-1/4" x 5-1/2" (.065"W) Top and Bottom Rail	3" x 5"	Flat Cap
Wide Verticals	Any Standard DSI Aluminum Color (Shown on Page 3)	White Tan Mocha	48", 60", 72"	2" Standard Optional 7" Rackable Section (12" per 8' Section)	8' Per Ft. Section Widths Available	7/8" x 11.28" (.065"W) Snap Lock Tongue & Groove	1-1/4" x 5-1/2" (.065"W) Top and Bottom Rail	3" x 5"	Flat Cap

*Line and End Posts .070"W, Corner Post .090"W, Gate End Post .125"W.

Features



Line and End Post Cap

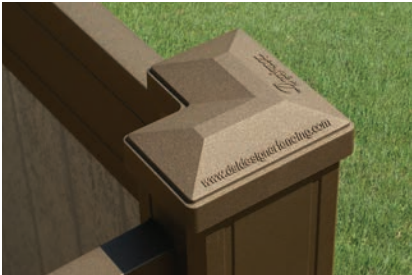

Corner Post Cap

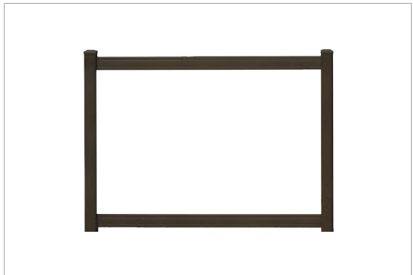

Posts and Rails can be ordered separately for use with your own infill



PICKET VINYL FENCING



Picket Style

There is nothing more Americana than white Picket Fencing. PolyRail® Picket Fencing provides a decorative boundary for your yard without blocking your view. Picket Fences are a stylish addition for both your front and back yards.

Good Neighbor Straight

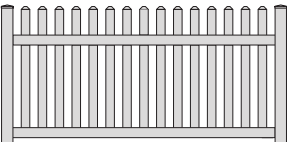

36", 42", 48"

Good Neighbor Concave

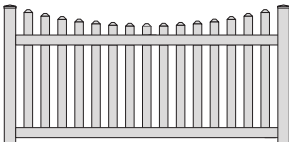

36", 42", 48"

Specifications

Models	Colors	Heights	Racking	Width	Vertical Size	Rails	Post Size	Standard Post Cap
Good Neighbor Straight	White Tan Mocha	36", 42", 48"	3" Standard	8'	7/8"x 3" (.080"W) Pickets w/3-11/16" Spacing	1-3/4" x 3-1/2" (.110"W) Top and Bottom Rail Aluminum Reinforced Bottom Rail	4" x 4" (.135"W)	Flat Cap
Good Neighbor Concave	White Tan Mocha	36", 42", 48"	3" Standard	8'	7/8"x 3" (.080"W) Pickets w/3-11/16" Spacing	1-3/4" x 3-1/2" (.110"W) Top and Bottom Rail Aluminum Reinforced Bottom Rail	4" x 4" (.135"W)	Flat Cap

Features



Good Neighbor Bottom Rail H-Channel Aluminum Reinforcement

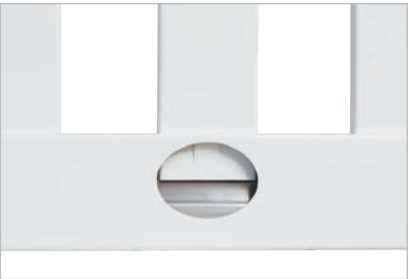

Good Neighbor Notched Pickets

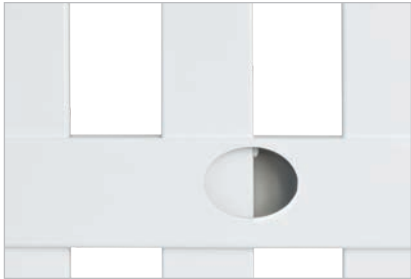

Good Neighbor Hidden Screw Top Rail Support Center Picket



ORNAMENTAL

VINYL FENCING



Ornamental Style

The timeless beauty of our Ornamental Fencing adds a touch of elegance to your outdoor living space. Good Neighbor Yard adds safety to either your front or back yard while offering a stylish addition to your home.

Good Neighbor Yard

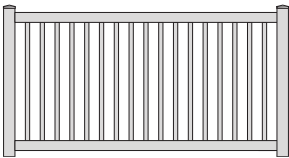

36", 42", 50-1/2"

Specifications

Models	Colors	Heights	Racking	Width	Vertical Size	Rails	Post Size	Standard Post Cap
Good Neighbor Yard	White Tan Mocha	36", 42", 50-1/2"	6" Standard	8'	7/8" x 1-1/2" (.070"W) Verticals w/3-11/16" Spacing	1-3/4" x 3-1/2" (.110"W) Top and Bottom Rail Aluminum Reinforced Bottom Rail	4" x 4" (.135"W)	Flat Cap

Feature



Good Neighbor Bottom Rail H-Channel Aluminum Reinforcement



POST & RAIL

VINYL FENCING



Post & Rail Style

Post & Rail Fencing offers simplicity and open design for your landscape. Post & Rail Fencing includes 2, 3, and 4 rail models as well as a Crossbuck model.

2-Rail



Mocha available for Models with 1-1/2" x 5-1/2" Rails

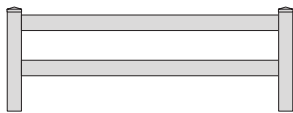

36"

3-Rail

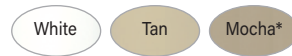

Mocha available for Models with 1-1/2" x 5-1/2" Rails

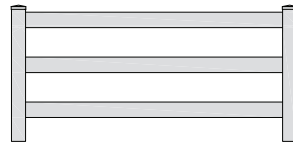

48", 52"

4-Rail



Mocha available for Models with 1-1/2" x 5-1/2" Rails

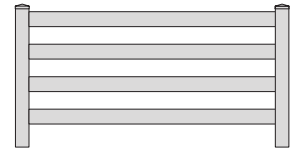

52"

Crossbuck

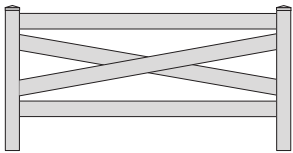

50-1/2"

Specifications

Models	Colors	Heights	Width	Rails	Rail Spacing	Post Length	Post Size	Standard Post Cap
2-Rail	White, Tan, Mocha	36"	8'	1-1/2" x 5-1/2" Ribbed (.090"W)	10-1/2"	5-1/2' (.135"W)	5" x 5"	Flat Cap
3-Rail	White, Tan, Mocha	48", 52"	8'	1-1/2" x 5-1/2" Ribbed (.090"W)	10-1/2"	6-1/2' (.135"W) 7' (.135" or .165"W) 7-1/2' (.165"W)	5" x 5"	Flat Cap
	White, Tan	52"	8'	2" x 6" Hollow (.090"W)	10-1/2"	7' (.165"W) 7-1/2' (.165"W)	5" x 5"	Flat Cap
4-Rail	White, Tan, Mocha	52"	8'	1-1/2" x 5-1/2" Ribbed (.090"W)	6-1/2"	7' (.135" or .165"W) 7-1/2' (.165"W)	5" x 5"	Flat Cap
	White, Tan	52"	8'	2" x 6" Hollow (.090"W)	6-1/2"	7' (.165"W) 7-1/2' (.165"W)	5" x 5"	Flat Cap
Crossbuck	White, Tan, Mocha	50-1/2"	8'	1-1/2" x 5-1/2" Ribbed (.090"W)		7' (.135"W)	5" x 5"	Flat Cap

STANDARD GATES

Each of our PolyRail® Vinyl Fencing models have optional matching Walk Gates. All Walk Gates include an aluminum reinforced frame. Walk Gates are available in single and double gate options.

Walk Gates

Gate Models	Single Gate Opening Widths					Double Gate Opening Widths				
	36"	42"	48"	60"	72"	72"	84"	96"	120"	144"
Tri-Max II	•	•	•	•		•	•	•	•	
Tri-Max II w/Vertical Topper	•	•	•	•		•	•	•	•	
Tri-Max II w/Lattice Topper	•	•	•	•		•	•	•	•	
Designer Fence	•	•	•	•	•	•	•	•	•	•
Good Neighbor Picket			•	•	•			•	•	•
Good Neighbor Yard	•	•	•	•	•	•	•	•	•	•



Post & Rail Gates

Gate Models	Single Gate Opening Widths						Double Gate Opening Widths					
	48"	72"	96"	120"	144"	192"	96"	144"	192"	240"	288"	384"
2-Rail Vinyl	•	•	•	•			•	•	•	•		
2-Rail Aluminum	•	•	•	•	•	•	•	•	•	•	•	•
3-Rail Vinyl	•	•	•	•			•	•	•	•		
3-Rail Aluminum	•	•	•	•	•	•	•	•	•	•	•	•
4-Rail Vinyl	•	•	•	•			•	•	•	•		
4-Rail Aluminum	•	•	•	•	•	•	•	•	•	•	•	•
4-Rail Crossbuck	Gates not available in Crossbuck model. See 4-Rail.											



Features



Good Neighbor Yard Aluminum Reinforced Gate Frame

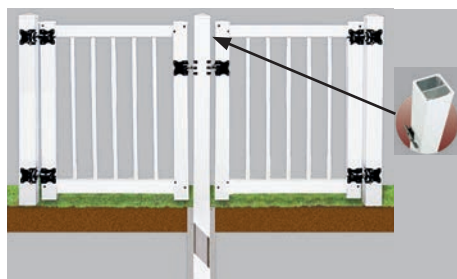

Removable Center Post is Recommended on Double Gates.

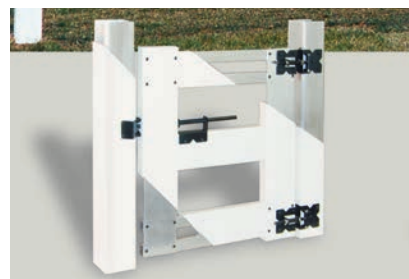

Post & Rail Aluminum Reinforced Gate Frame

ALUMINUM FRAME GATES

DSI offers both Welded and Adjustable Aluminum Frame Gates. These gates have a powder coated aluminum frame and vinyl infills designed for strength and durability.

Adjustable Gates

Welded Gates

Frame Colors	Infill Colors	Infill Size	Heights	Post Size	Single Gate Openings	Infill Size	Heights	Post Size	Single Gate Openings
Any Standard DSI Aluminum Color (Shown on Page 3)	White Tan Cottage Grey Sienna	7/8" x 6" (.045"W) Snap Lock Tongue & Groove	72"	6" Square Aluminum 6-5/8" Round Bollard (Not Available from DSI)	72", 96", 120"	7/8" x 6" (.045"W) Snap Lock Tongue & Groove	72"	6" Square Aluminum 6-5/8" Round Bollard (Not Available from DSI)	72", 84", 96", 120"
		7/8" x 6" (.045"W) Snap Lock Tongue & Groove	84", 96" with Mid-Rail	6" Square Aluminum 6-5/8" Round Bollard (Not Available from DSI)	72", 96", 120"	7/8" x 6" (.045"W) Snap Lock Tongue & Groove	84", 96" with Mid-Rail	6" Square Aluminum 6-5/8" Round Bollard (Not Available from DSI)	60", 72", 84", 96", 120"
Gloss Mocha Any Standard DSI Aluminum Color (Shown on Page 3)	Antique Beige Mocha	7/8" x 6" (.045"W) Snap Lock Tongue & Groove	72"	6" Square Aluminum 6-5/8" Round Bollard (Not Available from DSI)	72", 96", 120"	7/8" x 6" (.045"W) Snap Lock Tongue & Groove	72"	6" Square Aluminum 6-5/8" Round Bollard (Not Available from DSI)	72", 84", 96", 120"
		7/8" x 6" (.045"W) Snap Lock Tongue & Groove	84", 96" with Mid-Rail	6" Square Aluminum 6-5/8" Round Bollard (Not Available from DSI)	72", 96", 120"	7/8" x 6" (.045"W) Snap Lock Tongue & Groove	84", 96" with Mid-Rail	6" Square Aluminum 6-5/8" Round Bollard (Not Available from DSI)	60", 72", 84", 96", 120"
Any Standard DSI Aluminum Color (Shown on Page 3)	White Tan	7/8" x 11.28" (.065"W) Snap Lock Tongue & Groove	72"	6" Square Aluminum 6-5/8" Round Bollard (Not Available from DSI)	72", 96", 120"	7/8" x 11.28" (.065"W) Snap Lock Tongue & Groove	72"	6" Square Aluminum 6-5/8" Round Bollard (Not Available from DSI)	72", 84", 96", 120"
		7/8" x 11.28" (.065"W) Snap Lock Tongue & Groove	84", 96" with Mid-Rail	6" Square Aluminum 6-5/8" Round Bollard (Not Available from DSI)	72", 96", 120"	7/8" x 11.28" (.065"W) Snap Lock Tongue & Groove	84", 96" with Mid-Rail	6" Square Aluminum 6-5/8" Round Bollard (Not Available from DSI)	60", 72", 84", 96", 120"
Gloss Mocha Any Standard DSI Aluminum Color (Shown on Page 3)	Mocha	7/8" x 11.28" (.065"W) Snap Lock Tongue & Groove	72"	6" Square Aluminum 6-5/8" Round Bollard (Not Available from DSI)	72", 96", 120"	7/8" x 11.28" (.065"W) Snap Lock Tongue & Groove	72"	6" Square Aluminum 6-5/8" Round Bollard (Not Available from DSI)	72", 84", 96", 120"
		7/8" x 11.28" (.065"W) Snap Lock Tongue & Groove	84", 96" with Mid-Rail	6" Square Aluminum 6-5/8" Round Bollard (Not Available from DSI)	72", 96", 120"	7/8" x 11.28" (.065"W) Snap Lock Tongue & Groove	84", 96" with Mid-Rail	6" Square Aluminum 6-5/8" Round Bollard (Not Available from DSI)	60", 72", 84", 96", 120"
Any Standard DSI Aluminum Color (Shown on Page 3)	N/A - Frame Only	N/A - Frame Only	72"	6" Square Aluminum 6-5/8" Round Bollard (Not Available from DSI)	72", 96", 120"	N/A - Frame Only	72"	6" Square Aluminum 6-5/8" Round Bollard (Not Available from DSI)	72", 84", 96", 120"
	N/A - Frame Only	N/A - Frame Only	84", 96" with Mid-Rail	6" Square Aluminum 6-5/8" Round Bollard (Not Available from DSI)	72", 96", 120"	N/A - Frame Only	84", 96" with Mid-Rail	6" Square Aluminum 6-5/8" Round Bollard (Not Available from DSI)	60", 72", 84", 96", 120"

Adjustable Aluminum Frame Gates



Welded Aluminum Frame Gates

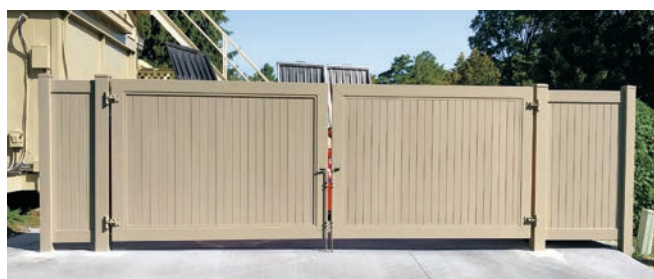

GATE HARDWARE

Hinges

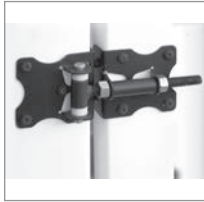

Residential Hinge



Tru-Close Hinge

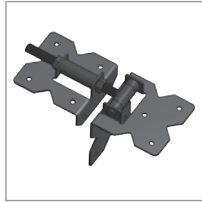

Commercial Hinge for Post & Rail or Aluminum Frame Gates

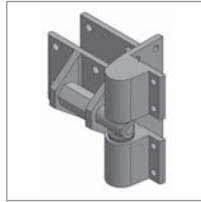

HD Adjustable Hinge for 1-1/2" Gate Side

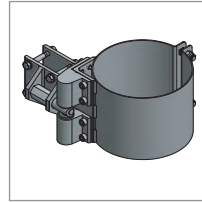

Adjustable Bollard Hinge for 6-5/8" Round Posts



Mocha and Tan are available for **select** products. Please contact customer service for availability.

Latches



Residential Latch



Magna Latch Vertical Pull 6"



Magna Latch Vertical Pull 20-1/4"



Lokk Latch



Lokk Latch Deluxe



Mocha and Tan are available for **select** products. Please contact customer service for availability.



FortiMa Latch

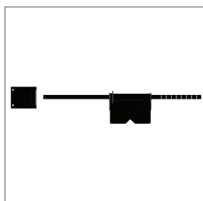

Commercial Latch for Post & Rail



Sentry Latch for use on double gates (Walk or Aluminum Frame) that only require access to the latch from one side of the gate

Canebolt

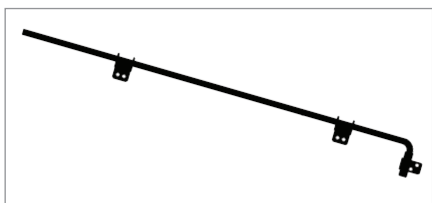

Canebolt (Drop Pin Kit)



ACCESSORIES

Vinyl Post Caps



External Flat Cap



Gothic Cap



Ball Cap



Trim Cap



Internal Flat Cap
(For Post & Rail)



Mocha and Sienna are available for **select** products. Please see individual product pages for availability.

Magenta Star® Post Cap Lighting

Magenta Star® Ornamental Low Voltage and Solar Lights.
Visit magenastar.com for more information and to see additional styles and options.



Ornamental
Low Voltage 4"

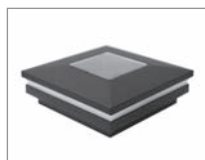

Ornamental
Solar 4"



Ornamental
Low Voltage 5"

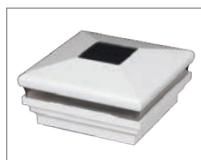

Ornamental
Solar 5"



Mocha is available for **select** products. Please see individual product pages for availability.

Tools



Template Kit



Notching Tool

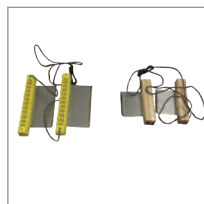

Rail Removers



**Digger
Specialties
Inc.**

Transforming the Outdoor Living Experience™

DSI Family of Products

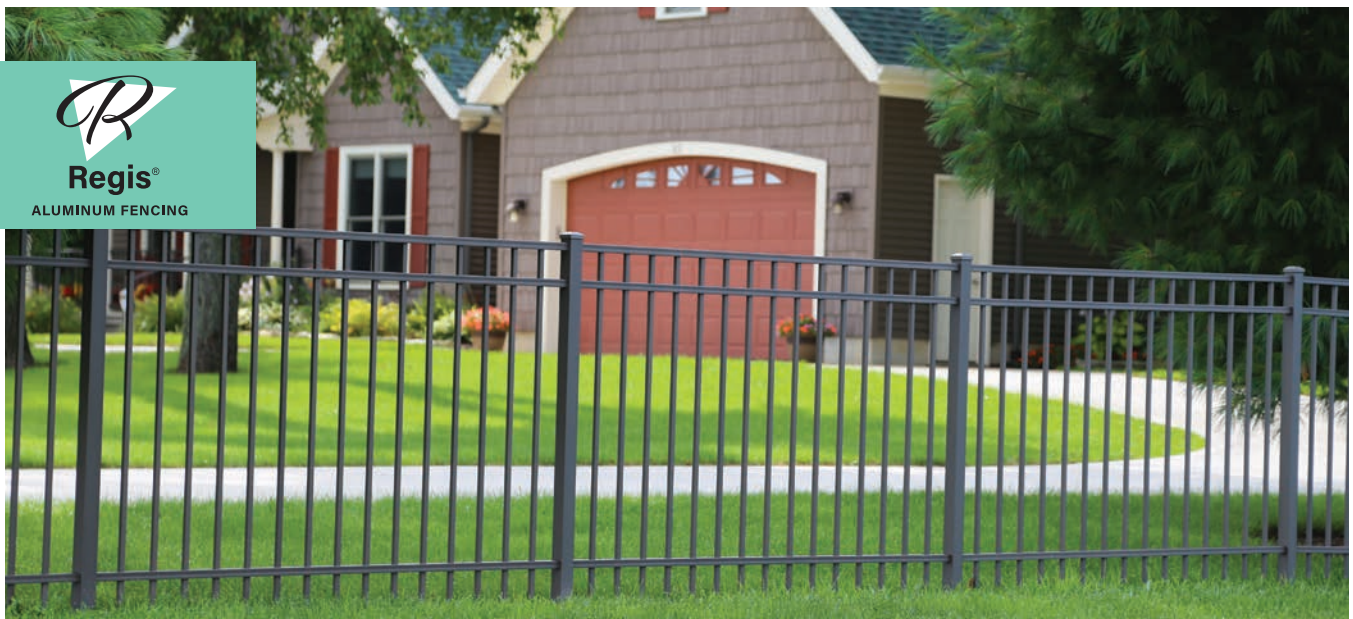

diggerspecialties.com

Stay Connected



We have tried to make this brochure comprehensive and factual. We reserve the right to discontinue at any time, without notice, colors, materials, equipment and availability. Since some information may have been updated since the time of printing, we are not responsible for typographical or pictorial errors. Materials shown may vary slightly from actual colors. ©Digger Specialties 2021/05 99512